



**CELİK**  
KIRMA ELEME

[www.celikkirmaeleme.com](http://www.celikkirmaeleme.com)



## ÇELİK CRUSHING SCREENING MACHINES AND SPARE PARTS

Çelik Kırma Eleme was founded in 2011 by Hakan ÇELİK. It has not been give up its quality service with its expert and experienced personnel since it was founded. Castings of our company is our own production and high quality castings. Depending on the demands of the companies, we make the desired material and quality castings .

In our Ostim workshop, with expert and experienced personnel we manufacture machines and belt conveyors and also we repair and maintenance crusher machines.

Also we have services like purchase and sale of 2nd hand crushers , assembly and disassembly of plants and plant closure.

## DOMESTIC REFERENCES

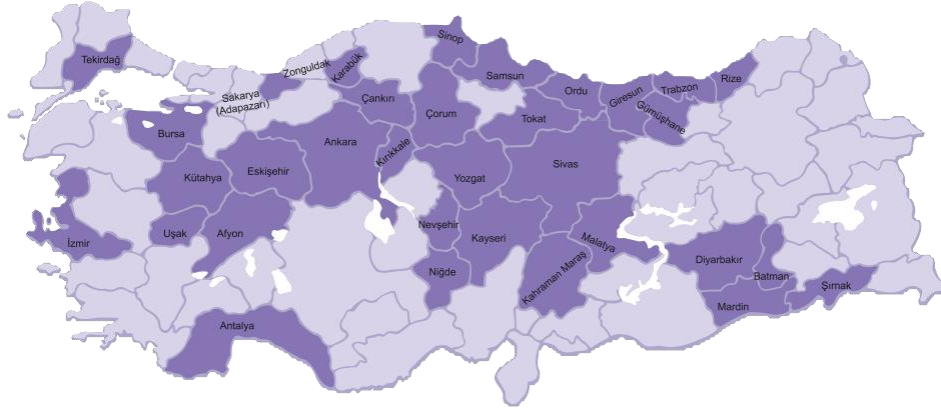

## OVERSEAS REFERENCES

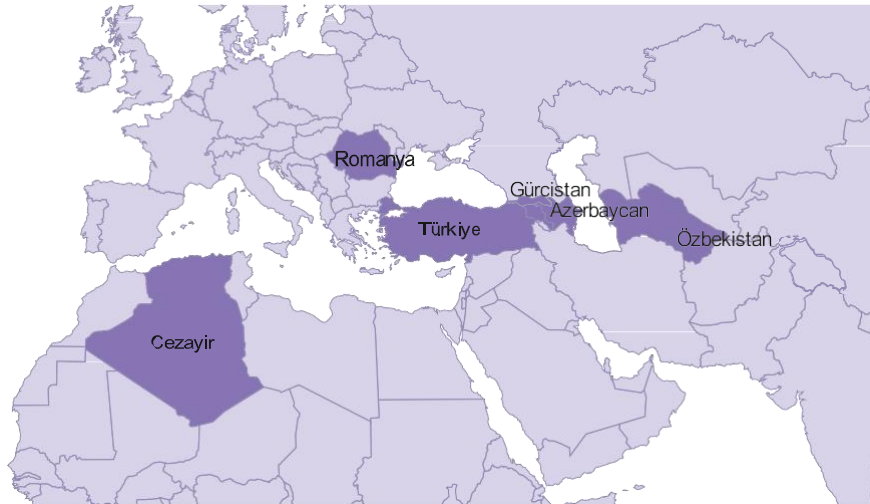

## JAW CRUSHERS

They are efficient and low cost crushers with high quality steel casting parts and durable wear parts. Jaw crushers are produced as primary and secondary crushers, one of which is stationary and the other is mobile. This two parts able to crush from the soft limestone to the hardest basal and it is the most used type of crusher. Our jaw crushers are equipped with a central hydraulic system mechanism. With this system, according to the product we want to take from the machine with the help of the hydraulic system forward and back pitman, the necessary protection and removal of the necessary plates behind the adjustment block, the adjustment allows the protection and removal of the necessary plates on the back of the block. Jaw crushers are designed as fixed and mobile.

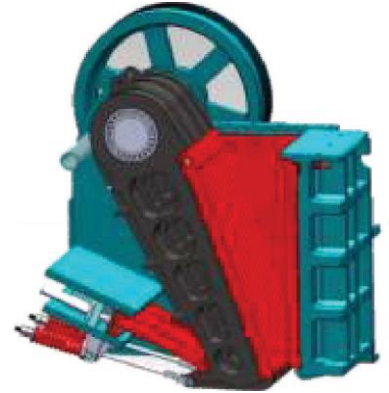

### PRIMARY JAW CRUSHERS

MODEL	JAW MEASUREMENT(mm)	ENGINE (kW)	FLYWHEEL TRANSFER(d.d)	WEIGHT(kg)
K03	900-650	75-1000	293	11400
K07	1100-850	132-1000	228	33000

### FLYWHEEL TRANSFER

MODEL	JAW MEASUREMENT(mm)	ENGINE (kW)	FLYWHEEL TRANSFER	WEIGHT(kg)
K04	900x200	30-1500	330	6000
K12	1100x350	55-1500	485	11000



Ayar Bloğu



Chin Spindle



Tensioner Fork



Grease Holder



Grease Holder



K03 Wedge



K03 Jaw



Support Plate Holder



Bearing Plate



Pitman Labyrinth Cover



Pitman Labyrinth



Fixed Jaw Clamp



Fixed Jaw



Flywheel



Side Slot Outer Labyrinth Cover



Side Slot External Labyrinth



Sideslot interior Labyrinth Cover



Side Sockets Inside Labirent

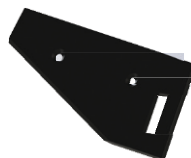

Side liner 1



Sideline 2



Side liner 3

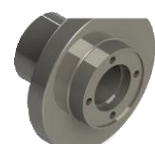

Slot

## Primary Impact Crushers

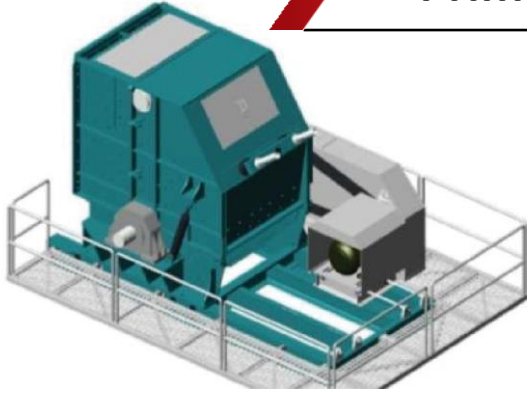

These crushers are designed to break the abrasive rock material of medium hardness. In the crusher system of this crusher, like the other impact crushers, the material that entering into the crusher is thrown by the rotor pallet and crushed to the walls of the crusher to break the material.



MODEL	ROTOR SIZE(mm)	FEEDING SIZE(mm)	CAPACITY (ton/hour)	ENGINE (kW)	WEIGHT(kg)
CLK-PDK-01	1400x1540	1000x1000	350-400	2x132	28000
CLK-PDK-02	1400x1250	900x900	200-250	2x110	23000
CLK-PDK-03	1600x2000	1300x1300	400-600	2x250	52000

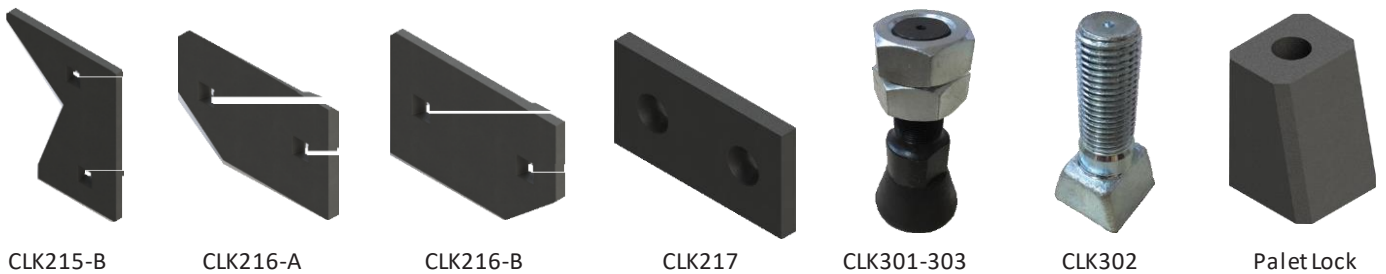
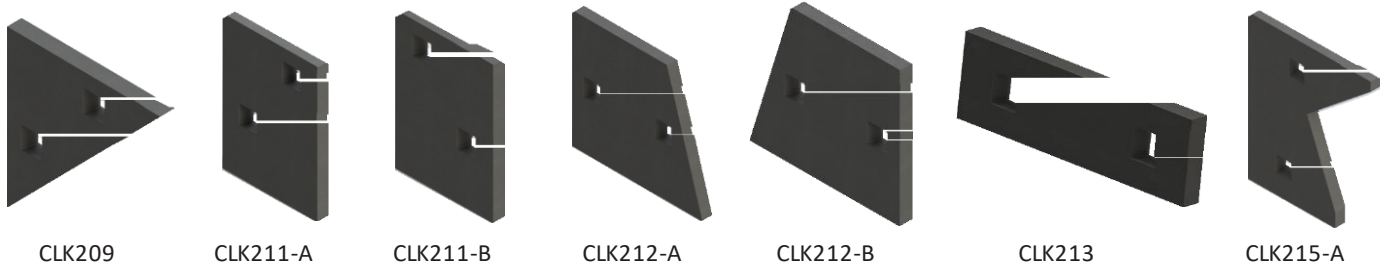
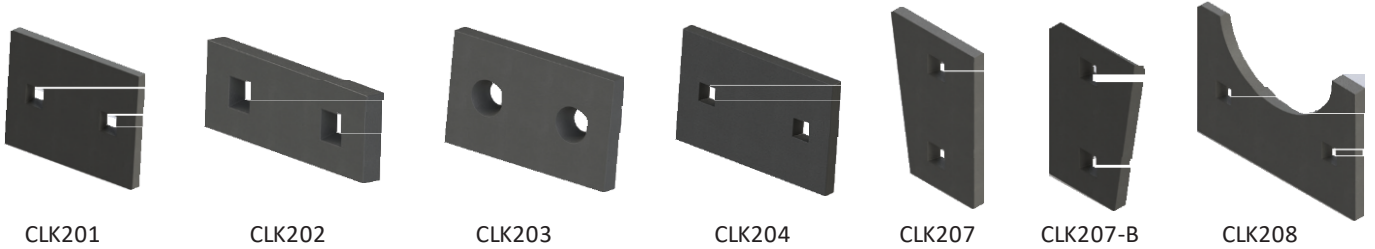

## SECONDARY IMPACT CRUSHERS

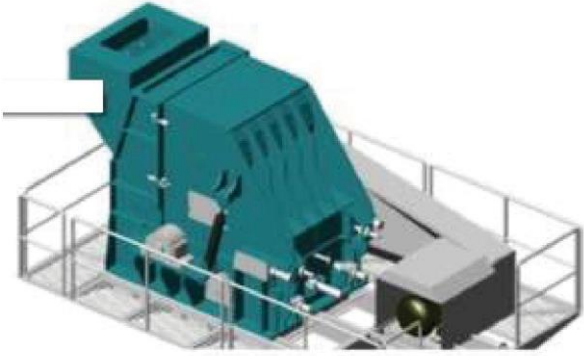

DMK series crushers are impact hammers with pendulum adjustment. DMK crushers are designed for medium hardness and hard materials (such as basalt, granite) to break in the size of concrete and asphalt aggregate and are used as secondary crushers. Machine upper side opens in the manner that unveil hidrolic mechanism with joint points, rotor and inside parts. With this feature, the assembly and disassembly of the castings are facilitated. These crushers are designed as three zones. The stone entering the crusher hits the crusher elements in the first zone by the rotor pallet and the first crushing phase is realized.

### SECONDARY IMPACT CRUSHERS

MODEL	ROTOR SIZE(mm)	FEEDING SIZE (mm)	CAPACITY (ton/hour)	ENGINE (kW)	WEIGHT(kg)
CDMK-01	1100x1000	200	120-150	160	14500
CDMK-02	1400x1250	250	200-250	200	18500
CDMK-03	1100x1400	350	300-350	250	20000

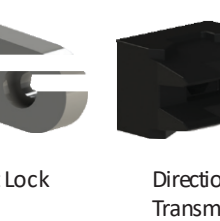
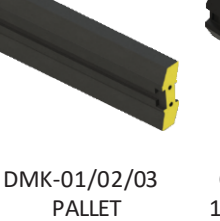
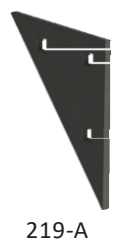
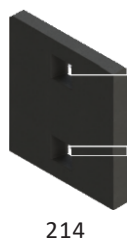
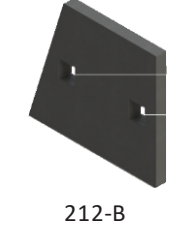
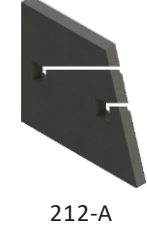
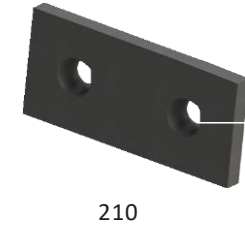
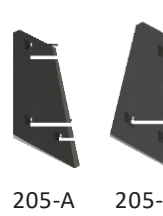
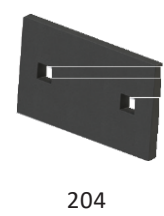
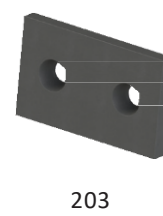
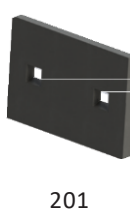

## Tertiary Crusher

Tertiary crushers are designed to break down soft and medium hard materials. The rotor of the Tertiary crushers can rotate in either direction, thus reducing the cost by using the four corners of the pallets. The stone entering into the Tertiary crusher is crushed by breaking the crushing rods which can be adjusted by the rotor palette and then the same process continues until the desired level of stone is reached.

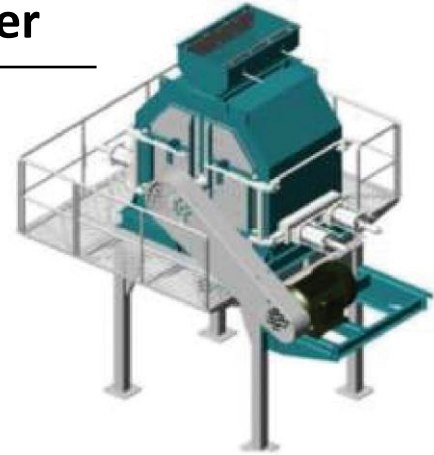

TYPE	ROTOR DIAMETER (mm)	THE LARGEST PIECE SIZE (mm)	CAPACITY (ton/saat)	ENGINE (kW)	WEIGHT (kg)	ROTOR CYCLE (d/dk)
CLK-TK-10	1400x1000	150	80-135	160/1500	15500	700-800
CLK-TK-12	1400x1200	150	120-170	250/1500	21000	700-800
CLK-TK-15	1400x1500	150	170-210	315/1500	25000	700-800

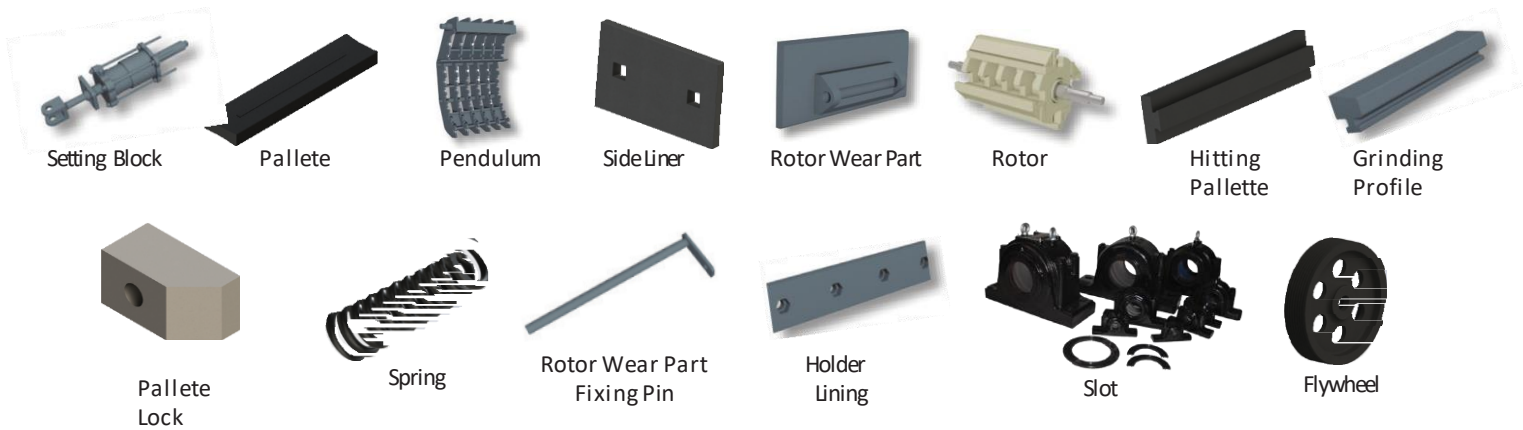

## SCREEN

In a crushing and screening plant, vibrating screens are designed to separate products of various sizes from the crusher. By means of the working system of the screen with the screen, the eccentric weight aid of the machine and the vibrations with the ellipse movements are separated gradually. Vibrating screens are manufactured as two, three or four layers. The sieves are produced as fixed and mobile. Can be manufactured as mobile and fixed according to demand.

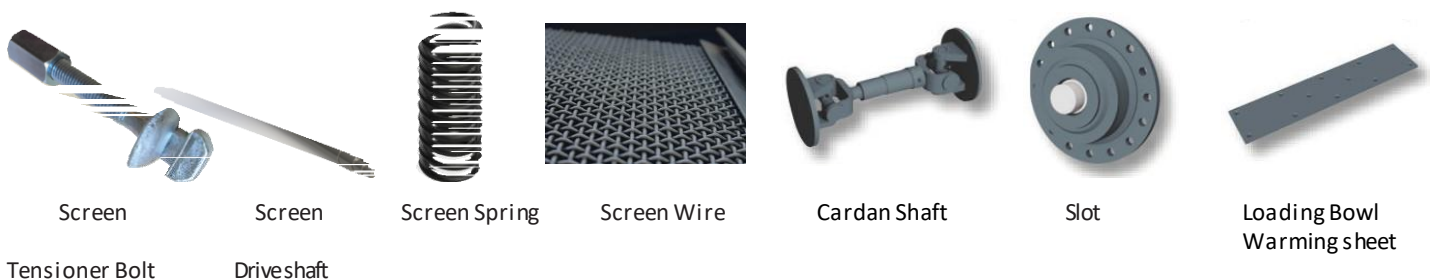

## VERTICAL CRUSHERS

Vertical Shaft Impactors; Sand quarries, stone quarries, ready-mixed concrete and mining industry can use the advantages and costs low 0-5 mm is a kind of crusher that increases the product intake. With Open rotor option ,hardness and abrasive high basalt, granite etc. more efficient crushing is provided in the these materials In order to increase the crushing efficiency in closed rotors, we are performing revision of the closed rotor with a closed rotor as an open rotor.



VSI MODEL	ROTOR DIAMETER (mm)	MAX FEEDING SIZE (mm)	ENGINE POWER(kw)	CAPACITY (TON/HOUR)			
				45 m/s	52 m/s	58 m/s	60 m/s
VSI-900-OR	975	90	260-370	300	250	-	-
VSI-900-OR	900-3	50	260-500	450	375	320	300
VSI-800-OR	900-2	40	200-320	250	230	205	190
VSI-700-OR	700	35	190-132	90	85	70	65



104

844

860

862

Lower Wear Plate 700

Lower Wear Plate

Feeding Ring

Feeding Ring

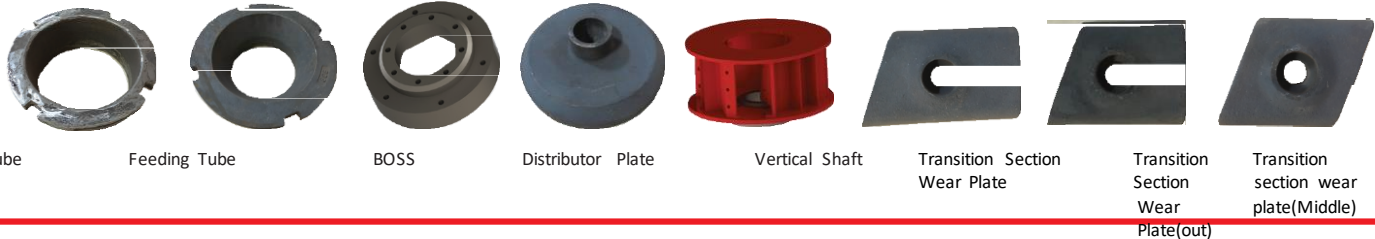

Feeding Tube

Feeding Tube

BOSS

Distributor Plate

Vertical Shaft

Transition Section Wear Plate

Transition Section Wear Plate(out)

Transition section wear plate(Middle)

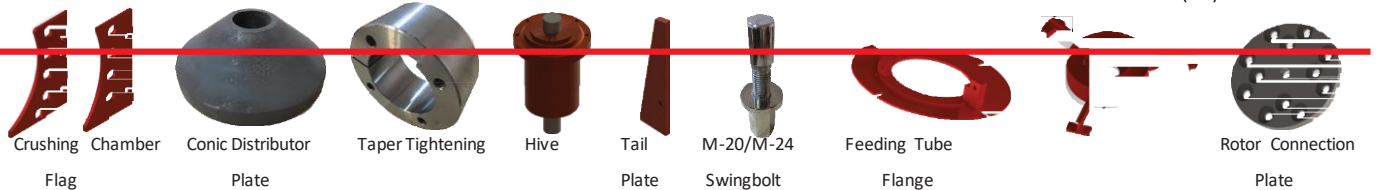

Crushing Chamber Flag

Conic Distributor Plate

Taper Tightening

Hive

Tail Plate

M-20/M-24 Swingbolt

Feeding Tube Flange

Rotor Connection Plate



Rotor Breaker Tip

Rotor Upper Plate

Upper Wear Plate (700)

Upper Wear Plate

Semi Circle Sheet

Star Anvil Cassette

## OPEN ROTOR



235

Open Rotor Connection Plate

Open Rotor Distributor Plate

Open Rotor Plate

anvil cassette

Anvil

Feeder Tank

Kanika Hammer

Upper Cap Wear Plate

Upper Kap Wear Plate

## BAND SYSTEM

It is a system that have different width,height,capacity and used for stone crushing, sieving, washing , stock range and transportation of material.

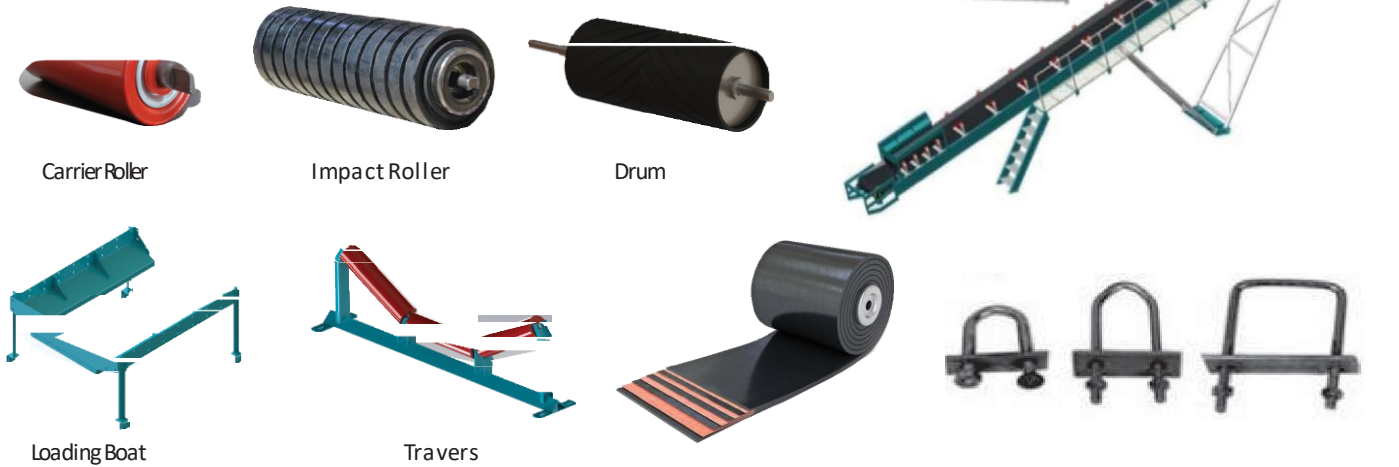

Belt conveyors are manufactured from bending sheet frame. Our belt conveyors, which stand out with their quality in design and manufacturing, are produced in 7 different widths as 650, 700, 800, 900, 1000, 1100, 1200 mm. We provide belt tire, u clamp, carrier roller, impact roller, drum, traverse, loading trough and trouser trough for the desired size and size used in belt conveyor systems.

## SPIRAL

The screw scrubbers wash the thin material from the sieve. The washed fine material collapses to the base and moves by the helical helices to the discharge chute and is ejected from the discharge chute. The water in the screw is drained from the channels in the helix body. The rubbers in the helical leaves reduce the cost of helical wear by reducing the cost and replacing the rubbers. Washing spirals are produced as double and single in various diameters and sizes. Minimizes spindle leakage thanks to pocket system.



TYPE	MODEL	ENGINE (kW)	INPUT CAPACITY (m <sup>3</sup> /hour)		SPIRAL CYCLE(cycle/min )	WATER NEED (m <sup>3</sup> /h)	WEIGHT(kg)
			0-3 mm	0-7 mm			
400x4000	CY24	5,5	16	27	24	15-30	2300
500x5000	CY25	7,5	25	42	24	25-45	2800
600x6000	CY26	7,5	35	55	20	35-55	5200
800x8000	CY27	11	45	70	20	45-65	6250



## OTHER MANUFACTURING

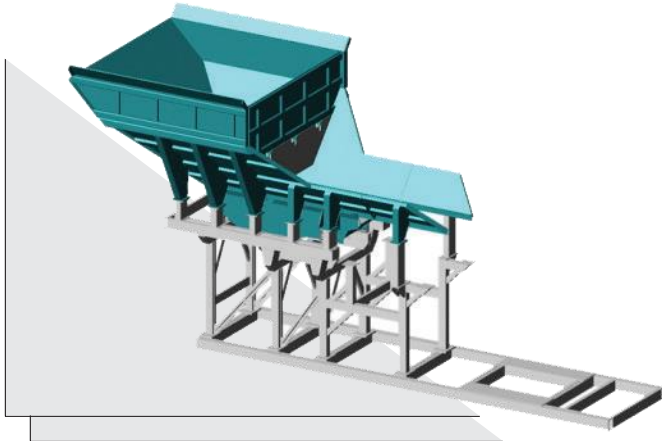

Primary Feeder(15m³)

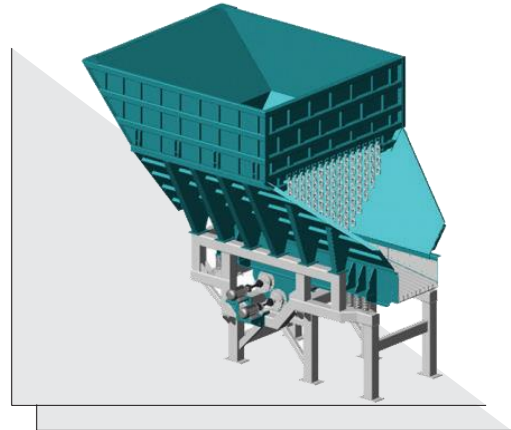

Primary Feeder(35m³)

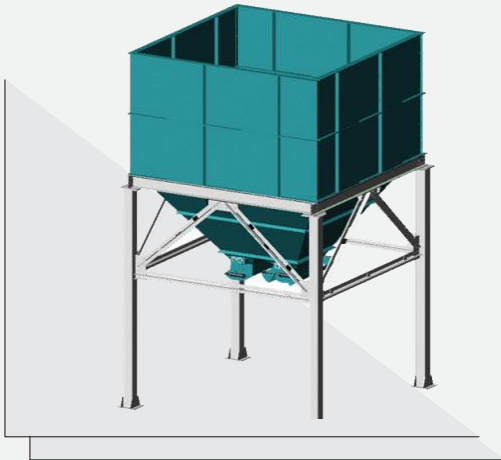

Truck Loading Bunker



Truck Loading Bunker

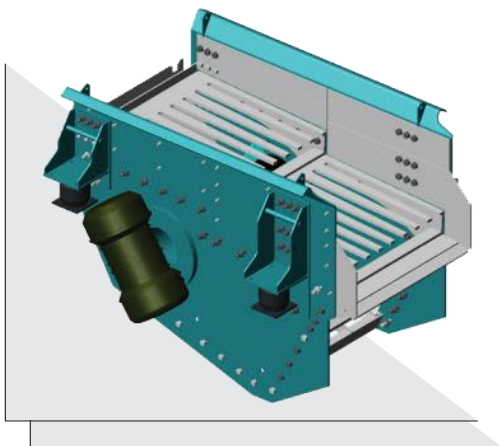

Front Screen with Grid

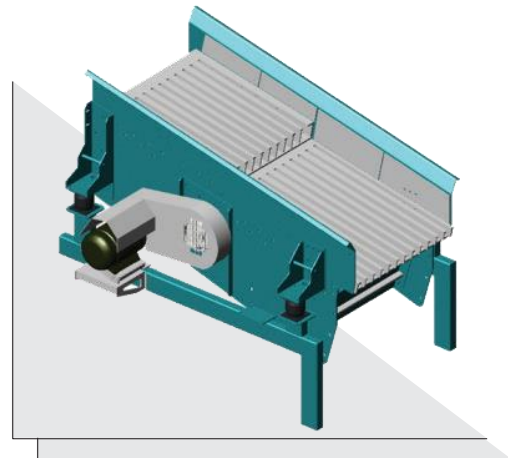

Front Screen with Grid

Screen Drive Shaft



PDK Shaft



CLK 14-14 ROTOR  
CLK 14-16 ROTOR

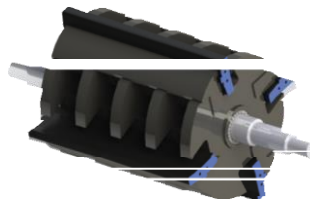

CDMK Rotor

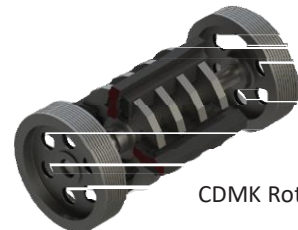

## CONCRETE PLANT



### Ready-Mixed CONCRETE PLANT

Ready-mixed concrete components are stocked, mixed under control, ready-mixed concrete production is carried out and the mixer-filled facilities are called 'Ready-mixed concrete'. Concrete batching plants are divided into two as "wet mix and dry mix" according to their mix shapes, and "bunker" and "star type" şekill according to their storage type.



In our company, zero machine manufacturing, machine repair maintenance and second-hand machine buying and selling is done. Every operation is done carefully with our experienced and expert personnel.

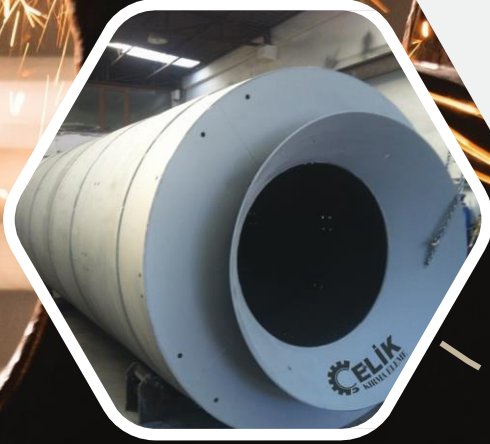
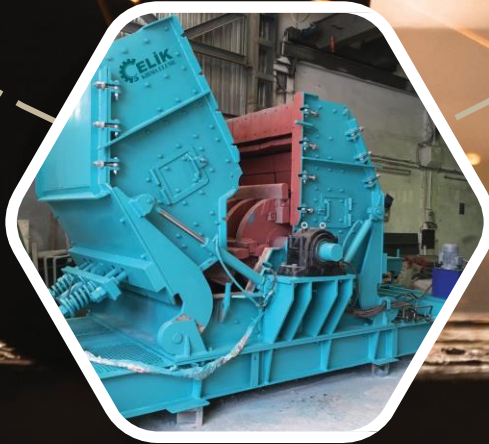



# CELİK KIRMA ELEME

📍 Çağdaş Emek Sanayi Sitesi 1475. Sk. No:  
65 (Eski 692. Sk.) Ostim / ANKARA

☎️ +90 31239593 10

📞 +90 31239593 10

📠 +90 5326221088

✉️ [info@celikkirmaeleme.com](mailto:info@celikkirmaeleme.com)

🌐 [www.celikkirmaeleme.com](http://www.celikkirmaeleme.com)